



Manufacturer	Model	Compatibility with DeltaFil Capsule
DMG	Applicap Dispenser (sale discontinued)	✓
GC	Capsule Applicator III	✓*
GC	Capsule Applicator IV	✗
GC	Capsule Applicator V	✓
Solventum (formerly 3M ESPE)	Applicap Applicator (orange marker)	✓*
Solventum (formerly 3M ESPE)	Maxicap Applicator (blue marker)	✗
SDI	Riva Applicator	✗

Information based on internal testing by DMG and provided without guarantee.

Dispenser compatibility overview



DeltaFil Capsule Short guide



Manufacturer	Model	Compatibility with DeltaFil Capsule
SDI	Riva Applicator 2	✓**
SDI	Riva Applicator PRO	✓
Ivoclar	Capsule Applicator	✗
Dentsply Sirona	Capsule Extruder 2	✓
VOCO	AC Applicator type 2	✓
VOCO	AC Applicator type 1	✓*

* Dispenser manufacturing variations may affect fit in the capsule holder
** Fit in capsule holder may be difficult

✓ Compatible ✗ Not compatible

DeltaFil Capsule application guide

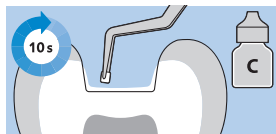

1. DeltaFil Conditioner (application time: 10 s)



2. Rinse and dry slightly (keeping the surface moist)

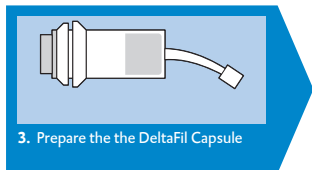

3. Prepare the the DeltaFil Capsule

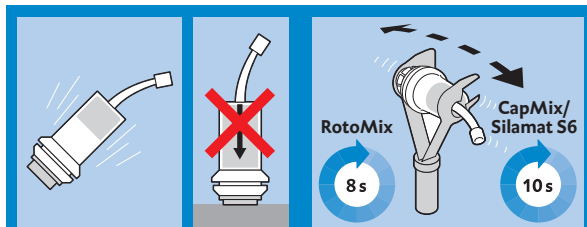

3a. Shake to loosen powder (do not activate on a surface like table top)

3c. Mix (immediately after activation)

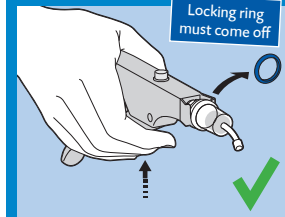

3b. Activate (by firmly pressing the dispenser lever once)

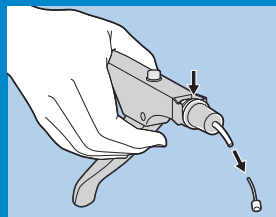

3d. Attach capsule and remove the sealing pin (apply within 10 s)



4. Application (< 10 s after mixing) and modeling (≤ 120 s after mixing has started (23 °C/73 °F))

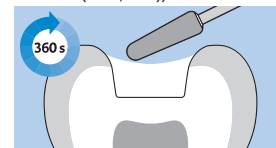

5. Finishing (> 360 s after mixing has started)

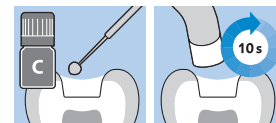

6. Optional: DeltaFil Coat (curing time 10 s (> 1000 mW/cm²))

DeltaFil preparation and restoration guide

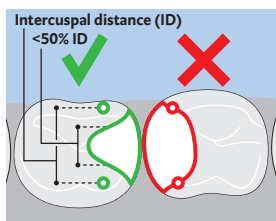

1. Limit cavity size / no involvement of cusp tips

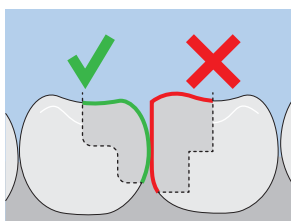

2. No over-contouring / no sharp edges

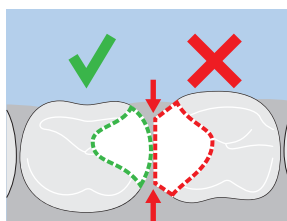

3. Horizontal walls / no beveling



Scan here for DeltaFil in use

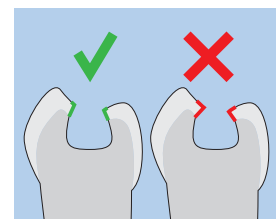
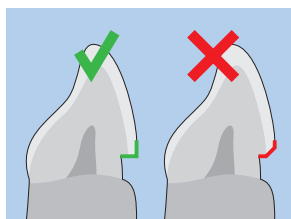

4. No unsupported enamel margins